

NOTE: height of garage panel level with house panel

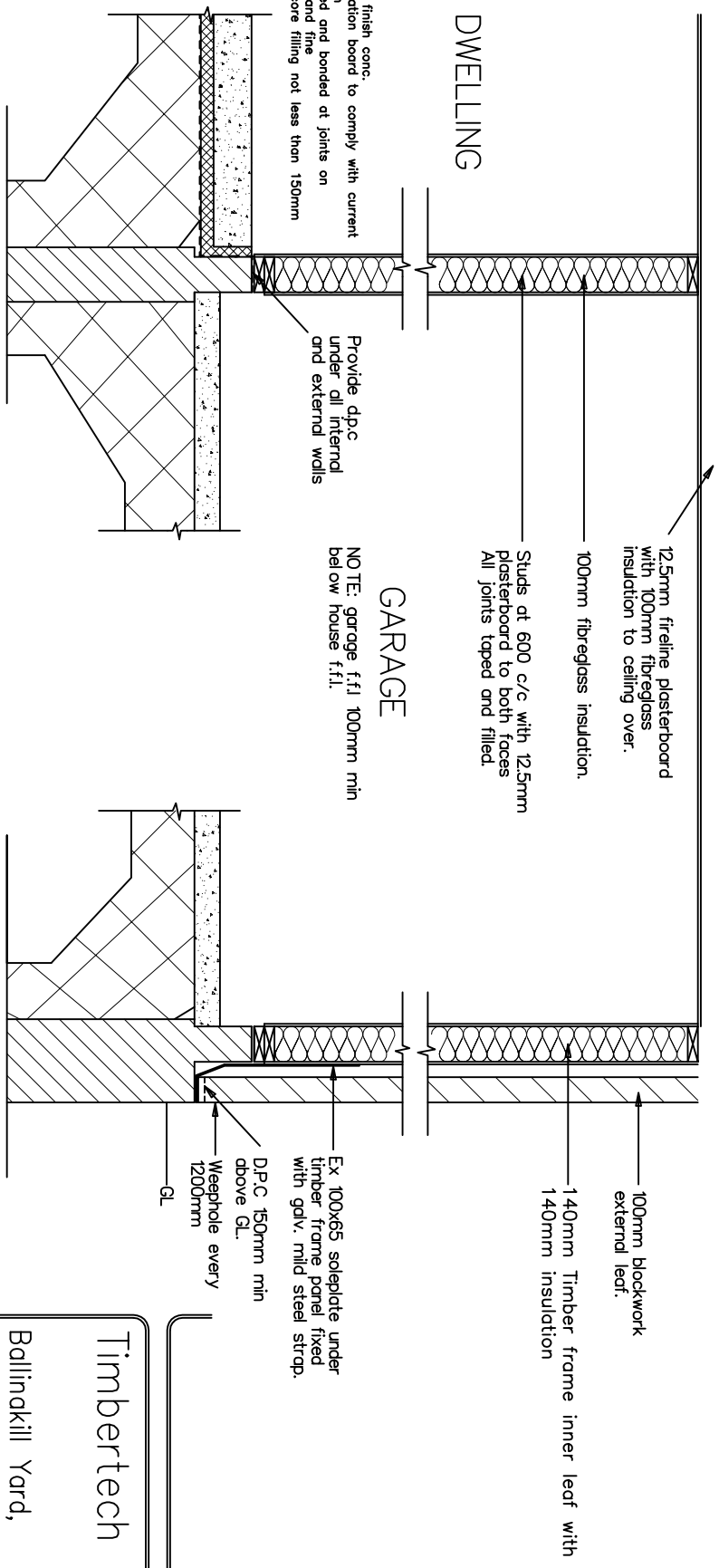

DWELLING

GARAGE

150mm powerfloat finish conc. floor slab on insulation board to comply with current Irish Bldg. Regs. on radon barrier taped and bonded at joints on mech. compacted and fine sand blinded hardcore filling not less than 150mm deep

Provide d.p.c. under all internal and external walls

NOTE: garage f.f.l 100mm min below house f.f.l.

12.5mm fireline plasterboard with 100mm fibreglass insulation to ceiling over.
100mm fibreglass insulation.
Studs at 600 c/c with 12.5mm plasterboard to both faces
All joints taped and filled.

100mm blockwork external leaf.
140mm Timber frame inner leaf with 140mm insulation

Ex 100x65 soleplate under timber frame panel fixed with galv. mild steel strap.
D.P.C. 150mm min above G.L.
Weephole every 1200mm
G.L.

Support of Timber Frame at Garage

NOTE: Concrete and substructure to building Regs approval.

Copyright 2017
RECEIVED, INSPECTED,
AND APPROVED -
DATE -
SIGN -

Timbertech Homes Ltd.
Bollinckill Yard,
Enfield,
Co. Meath.
Tel: ++353 (0) 46 954 2854
Fax: ++353 (0) 46 954 2853

| | |
|--|--|
| Client: Timbertech Homes Ltd. Bollinckill Yard Enfield, Co. Meath | Date: 13/11/2017 Drawn by: Fergal O' Malley |
| Title: Timber Frame at Garage | Drawing Nr: DET. 04 Project: Details |