

NOTE: height of garage panel level with house panel

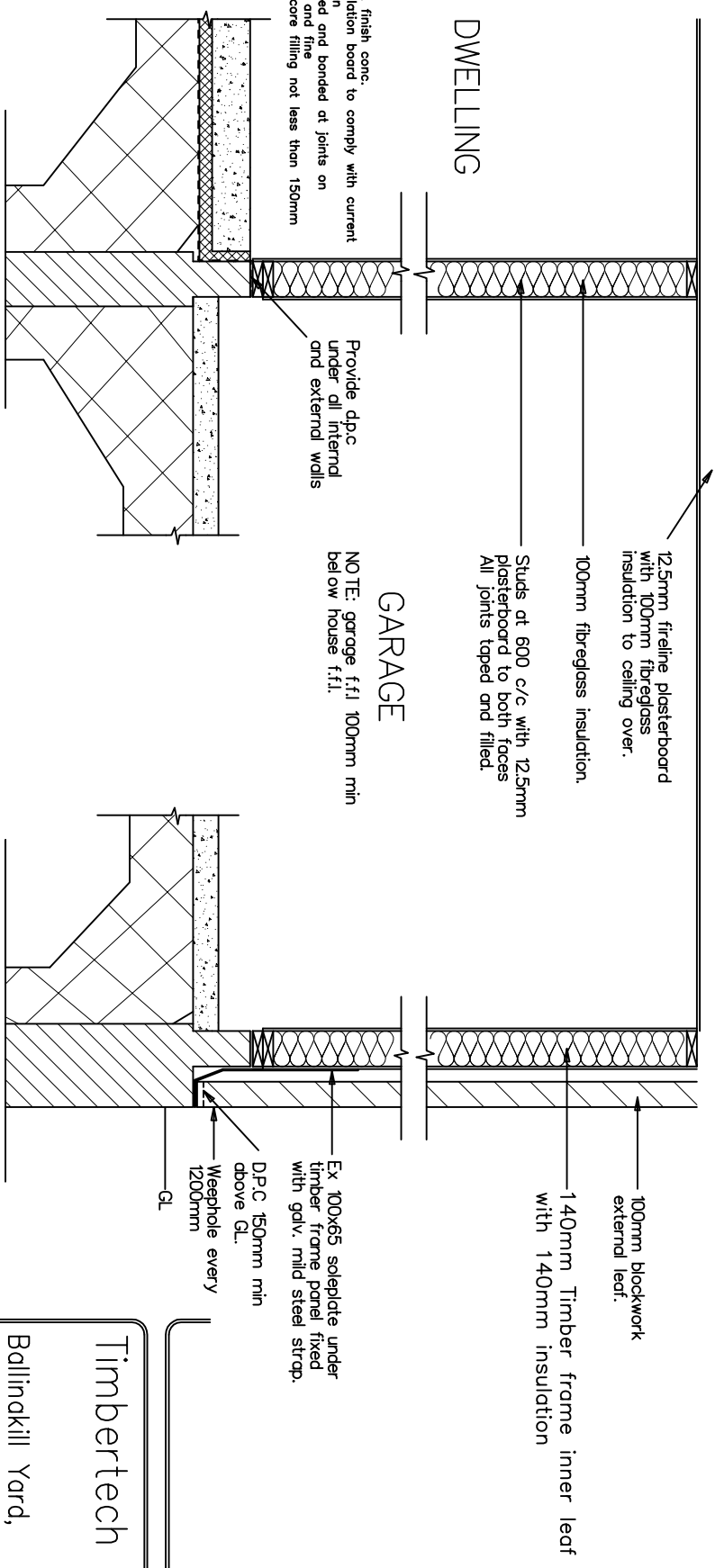

150mm powerfloat finish conc. floor slab on insulation board to comply with current Irish Bldg. Regs. on road borne traffic and bonded at joints on sand compacted and fine sand blinded hardcore filling not less than 150mm deep

Provide d.p.c. under all internal and external walls

NOTE: garage f.f.l 100mm min below house f.f.l.

DWELLING

GARAGE

12.5mm fireline plasterboard with 100mm fiberglass insulation to ceiling over.

100mm fiberglass insulation.

Studs at 600 c/c with 12.5mm plasterboard to both faces All joints taped and filled.

100mm blockwork external leaf.

140mm Timber frame inner leaf with 140mm insulation

Ex 100x65 soleplate under timber frame panel fixed with galv. mild steel strap.

D.P.C. 150mm min above GL.

Weephole every 1200mm

GL

Support of Timber Frame at Garage

NOTE: Concrete and substructure to building regs approval.

Copyright 2013
RECEIVED, INSPECTED,
AND APPROVED -
DATE - _____
SIGN - _____

Client: Timbertech Homes Ltd. Ballinkill Yard Enfield, Co. Meath		Date: 11/01/13 Drawn by: Fergal O'Malley
Title: Timber Frame at Garage		Drawing Nr: DET. 04 Project: Details

Timbertech Homes Ltd.
Ballinkill Yard,
Enfield,
Co. Meath.
Tel: ++353 (0) 46 954 2854
Fax: ++353 (0) 46 954 2853