

NOTE: Overall (o/o) timber frame dimensions refer to this face

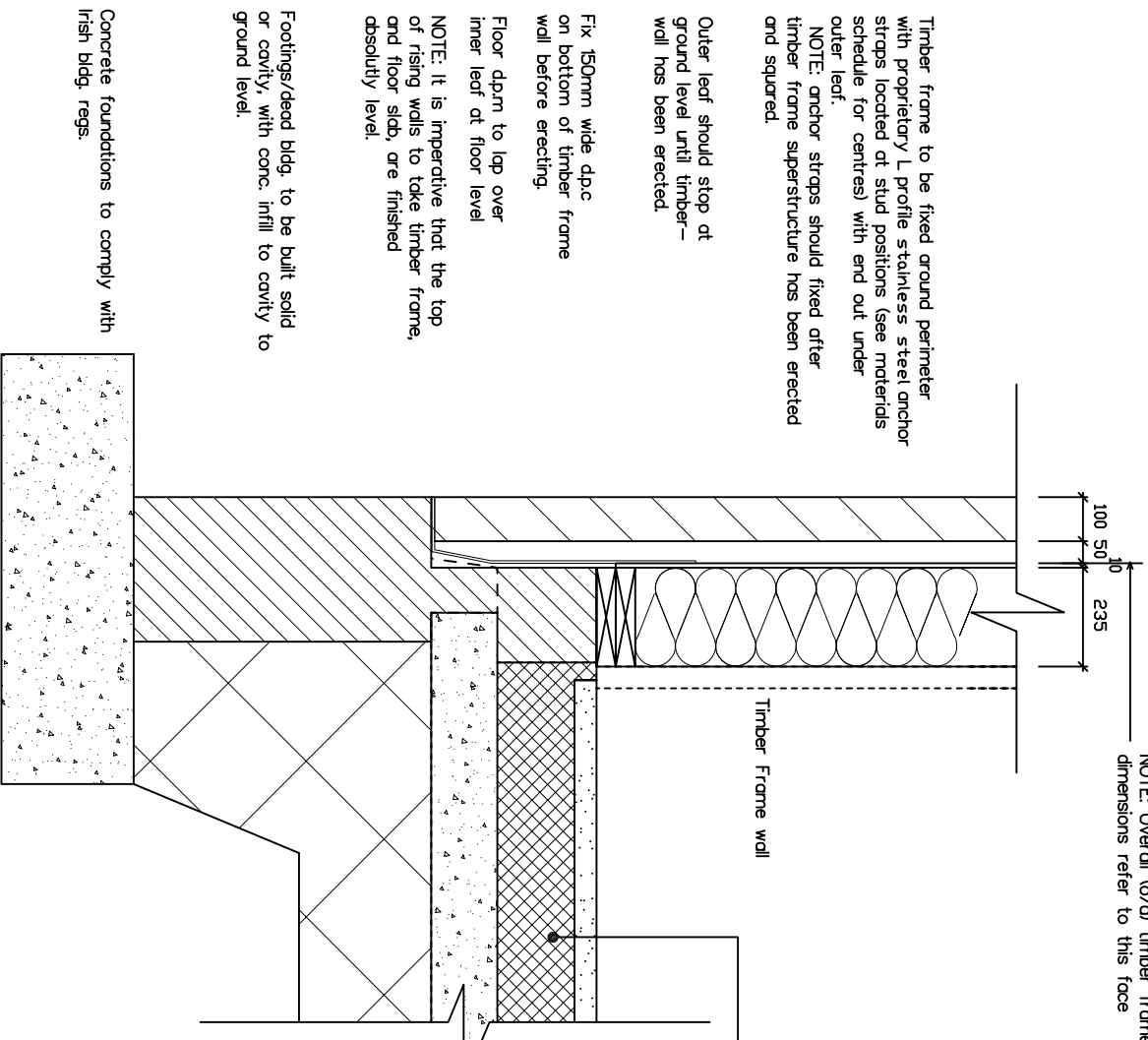

Timber frame to be fixed around perimeter with proprietary L profile stainless steel anchor straps located at stud positions (see materials schedule for centres) with end out under outer leaf.  
 NOTE: anchor straps should be fixed after timber frame superstructure has been erected and squared.

Outer leaf should stop at ground level until timber-wall has been erected.

Fix 150mm wide d.p.c on bottom of timber frame wall before erecting.

Floor d.p.m to lap over inner leaf at floor level

NOTE: It is imperative that the top of rising walls to take timber frame, and floor slab, are finished absolutely level.

Footings/dead bldg. to be built solid or cavity, with conc. infill to cavity to ground level.

Concrete foundations to comply with Irish Bldg. regs.

50mm conc. screed finish floor on board to comply with current Irish bldg. regs. on 150mm powerfloat conc. floor slab on radon barrier lapped and bonded at joints on mech. compacted and fine sand blinded hardcore filling not less than 150mm deep

Foundation/Base detail

Copyright 2017  
 RECEIVED, INSPECTED,  
 AND APPROVED -  
 DATE - \_\_\_\_\_  
 SIGN - \_\_\_\_\_

Timbertech Homes Ltd.  
 Ballinakill Yard,  
 Enfield,  
 Co. Meath.  
 Tel: ++353 (0) 46 954 2854  
 Fax: ++353 (0) 46 954 2853

Client: Timbertech Homes Ltd. Ballinakill Yard Enfield, Co. Meath	Date: 13/11/2017 Drawn by: Fergal O'Malley
Title: Foundation Detail - 235mm IF External Wall	Drawing Nr: DET_02 Project: Details